

Doctor Intra-Oral Reversal Instructions

Each full upward turn reverses the expander by 0.2 mm

ⓘ If reversing the Keyless Expander is necessary, it should be performed by the **doctor**, not the patient.

Reversal Kit Tools (provided upon request)

For Intra-Oral Reversal

a Wrench



⚠ When the wrench is reused for another patient, sterilize according to the parameters below

Steam Autoclave (Moist Heat)
Temperature: 121°C (250°F) or 134°C (273°F)
Exposure Time: 15–30 min
Pressure: 15–30 psi
Drying/Aeration Time: 15–30 minutes
Dry Heat Sterilization
Temperature: 160–170°C (320–338°F)
Exposure Time: 60–120 minutes

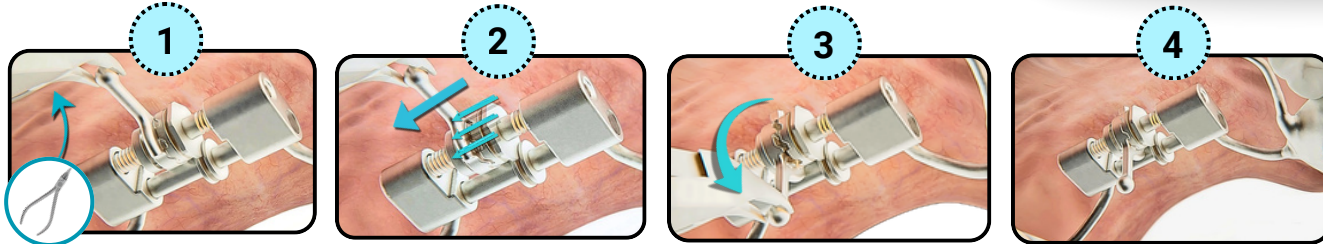

1 Hold the activation arm with a Weingart plier

2 Move the arm to your left (Patient's Right)

3 Lower all the way down

4 Remove plier from the arm

⚠ Ensure the teeth on each gear do not engage.



5 Place the wrench onto the hexagonal flange

6 Pull the wrench all the way up

7 Remove the wrench

8 Repeat previous steps until the desired amount of reversal is achieved

Doctor Extra-Oral Reversal Instructions

ⓘ Reversal of the Keyless Expander outside the mouth should be performed only by the technician or doctor

Reversal Kit Tools (provided upon request)

For Extra-Oral Reversal

b Flathead Screwdriver

c Gear Separator

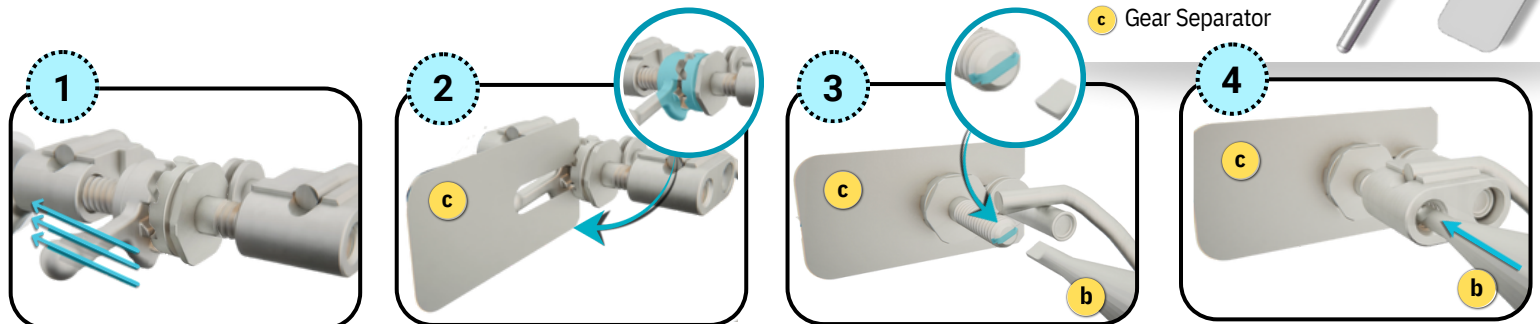

1 Move the activation arm to the left

2 Insert gear separator between the two gears to disengage them

3 Locate screwdriver slot

4 Insert the screwdriver into the screwdriver slot

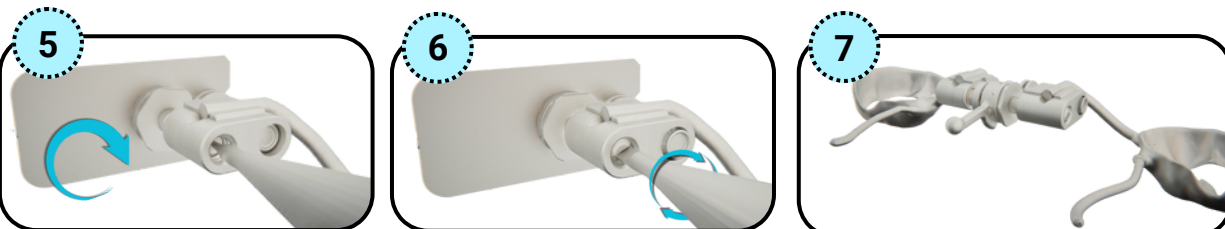

5 Turn the screwdriver **clockwise** to reverse expansion. 360° = 0.6mm

6 Keep **turning** until the desired amount of reversal is achieved

7 Remove the **screwdriver & gear separator**

Contact Us!

☎ 800-423-3270

🌐 SMLglobal.com

